



Belongs Material  
**304<sub>SS</sub> - 316<sub>SS</sub>**  
**321<sub>SS</sub>**

Flange Material  
**Carbon Steel**

Design Pressure  
**6 barg**

Design Temperature  
**400°C**

Flange drilling is per PN6  
 Movements are non-concurrent

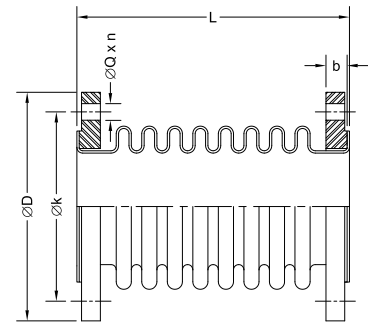

# FLOATING FLANGED

## PN6

Nominal Diameter (DN)	Movements (mm)		Length (L) (mm)	Spring Rates (N/mm)		D (mm)	k (mm)	b (mm)	n	Q (mm)	Effective Area (cm <sup>2</sup> )	
	Axial (+/-)	Lateral (+/-)		Axial	Lateral							
25	1"	15	6	120	62	31	100	75	14	4	11	18
32	1 1/4"	15	6	120	62	31	120	90	14	4	14	18
40	1 1/2"	15	7	125	54	31	130	100	14	4	14	23
50	2"	15	6	110	32	43	140	110	14	4	14	37
65	2 1/2"	15	6	120	34	60	160	130	14	4	14	58
		30	11	170	53	32						
80	3"	15	3	105	41	145	190	150	16	4	18	80
		30	12	205	66	37						
100	4"	15	3	115	71	301	210	170	16	4	18	129
		30	9	185	72	82						
125	5"	15	3	120	84	511	240	200	18	8	18	185
		30	8	200	78	121						
150	6"	15	2	120	105	814	265	225	18	8	18	268
		30	7	175	63	187						
200	8"	15	2	145	146	1279	320	280	20	8	18	451
		30	7	200	91	310						
250	10"	15	2	145	154	2049	375	335	22	12	18	682
		30	7	220	86	369						
300	12"	15	2	170	355	4380	440	395	22	12	22	945
		30	6	260	197	800						
		37,5	9	310	162	428						
350	14"	15	2	165	386	5669	490	445	22	12	22	1127
		30	6	260	214	1036						
		37,5	8	310	175	554						
400	16"	15	2	180	250	4046	540	495	22	16	22	1479
		30	5	230	178	1520						
		37,5	8	280	139	728						
450	18"	15	2	180	307	6177	595	550	24	16	22	1839
		30	4	230	219	2321						
		37,5	6	280	170	1111						
500	20"	15	2	180	279	6909	645	600	24	20	22	2264
		30	4	230	199	2596						
		37,5	6	280	155	1243						
600	24"	15	2	170	530	18745	755	705	24	20	26	3227
		30	4	240	331	5003						
		37,5	6	310	265	2379						
700	28"	15	2	190	419	14565	860	810	24	24	26	4372
		30	5	270	262	3797						
		37,5	5	310	262	3363						
800	32"	15	1	170	755	45102	975	920	24	24	30	5705
		30	3	230	503	14411						
		37,5	3	280	431	9278						
900	36"	15	1	190	1194	70128	1075	1020	26	24	30	7201
		30	3	255	796	22008						
		37,5	4	330	682	13061						
1000	40"	15	1	165	1037	70455	1175	1120	26	28	30	8885
		30	2	235	829	35891						
		37,5	4	330	592	13993						



Bellows Material  
**304ss-316ss**  
**321ss**

Flange Material  
**Carbon Steel**

Design Pressure  
**10<sub>barg</sub>**

Design Temperature  
**400°C**

Flange drilling is per PN10  
 Movements are non-concurrent

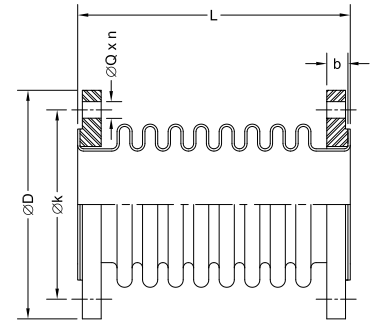

Nominal Diameter (DN)	Movements (mm)		Length (L) (mm)	Spring Rates (N/mm)		D (mm)	k (mm)	b (mm)	n	Q (mm)	Effective Area (cm <sup>2</sup> )
	Axial (+/-)	Lateral (+/-)		Axial	Lateral						
25 1"	15	6	125	62	31	115	85	16	4	14	18
32 1 1/4"	15	6	125	62	31	140	100	18	4	18	18
40 1 1/2"	15	7	155	93	30	150	110	18	4	18	23
50 2"	15	5	130	62	57	165	125	20	4	18	38
65 2 1/2"	15	4	130	68	95	185	145	20	8	18	58
	22,5	6	160	98	77						
80 3"	30	10	185	105	56	200	160	20	8	18	80
	15	4	130	66	124						
100 4"	22,5	6	165	90	95	220	180	22	8	18	129
	30	7	205	109	118						
125 5"	15	2	140	134	641	250	210	22	8	18	187
	22,5	4	170	104	274						
150 6"	30	7	210	107	169	285	240	24	8	22	268
	15	3	145	152	936						
200 8"	22,5	4	170	118	448	340	295	24	8	22	460
	30	6	210	127	245						
250 10"	15	3	175	211	1422	395	350	26	12	22	683
	22,5	5	210	158	584						
300 12"	30	7	230	140	385	445	400	26	12	22	945
	15	2	180	292	2687						
350 14"	22,5	5	235	195	888	505	460	26	16	22	1141
	30	7	275	159	499						
400 16"	15	2	165	355	4380	565	515	26	16	26	1483
	22,5	3	205	254	1567						
450 18"	30	6	245	197	840	615	565	28	20	26	1841
	15	2	170	582	8653						
500 20"	22,5	4	215	364	2417	670	620	28	20	26	2268
	30	5	255	323	1509						
500 20"	15	2	195	474	7707	670	620	28	20	26	2268
	22,5	3	210	339	3242						
500 20"	30	5	255	296	1867	670	620	28	20	26	2268
	15	1	185	587	11842						
500 20"	22,5	3	230	714	7176	670	620	28	20	26	2268
	30	4	270	555	3626						
500 20"	15	2	195	758	14195	670	620	28	20	26	2268
	22,5	3	235	649	8039						
500 20"	30	4	285	505	3733	670	620	28	20	26	2268

**PN10 FLOATING FLANGED**



Belongs Material  
**304<sup>ss</sup> - 316<sup>ss</sup>**  
**321<sup>ss</sup>**

Flange Material  
**Carbon Steel**

Design Pressure  
**16<sup>barg</sup>**

Design Temperature  
**400<sup>°C</sup>**

Flange drilling is per PN16  
 Movements are non-concurrent

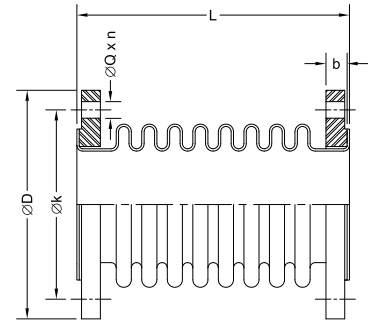

# FLOATING FLANGED PN16

Nominal Diameter (DN)		Movements (mm)		Length (L)	Spring Rates (N/mm)		D	k	b	n	Q	Effective Area
		Axial (+/-)	Lateral (+/-)	(mm)	Axial	Lateral	(mm)	(mm)	(mm)		(mm)	(cm <sup>2</sup> )
50	2"	15	4	120	117	109	165	125	18	4	4	38
		22,5	4	150	126	64						
65	2 1/2"	15	3	120	128	179	185	145	18	4	4	58
		22,5	7	150	124	97						
80	3"	30	8	180	182	99	200	160	20	8	8	80
		15	3	120	124	231						
100	4"	22,5	7	150	123	129	220	180	20	8	8	129
		30	9	180	166	121						
125	5"	15	3	125	145	484	250	210	22	8	8	186
		22,5	5	155	126	333						
150	6"	30	7	190	171	267	285	240	22	8	8	268
		15	2	130	350	2166						
200	8"	22,5	4	190	191	379	340	295	24	12	12	456
		30	5	230	513	3132						
250	10"	15	2	165	338	1242	405	355	26	12	12	684
		22,5	4	205	372	1517						
300	12"	30	5	245	335	1051	460	410	28	12	12	964
		15	2	200	675	5823						
350	14"	22,5	6	300	405	1282	520	470	30	16	16	1155
		30	7	370	739	7601						
400	16"	15	1	210	850	3840	580	525	32	16	16	1486
		22,5	4	290	858	4157						
450	18"	30	6	365	702	2184	640	585	32	20	20	1856
		15	3	240	869	11727						
500	20"	22,5	6	320	579	3504	715	650	34	20	20	2274
		30	11	405	434	1316						
		15	2	215	1048	22570						
		22,5	3	270	749	7967						
		30	6	330	582	3981						